

# LAMPIRAN

## 1. Studi Ruang Utama mixed use building

- Toko tipe 3

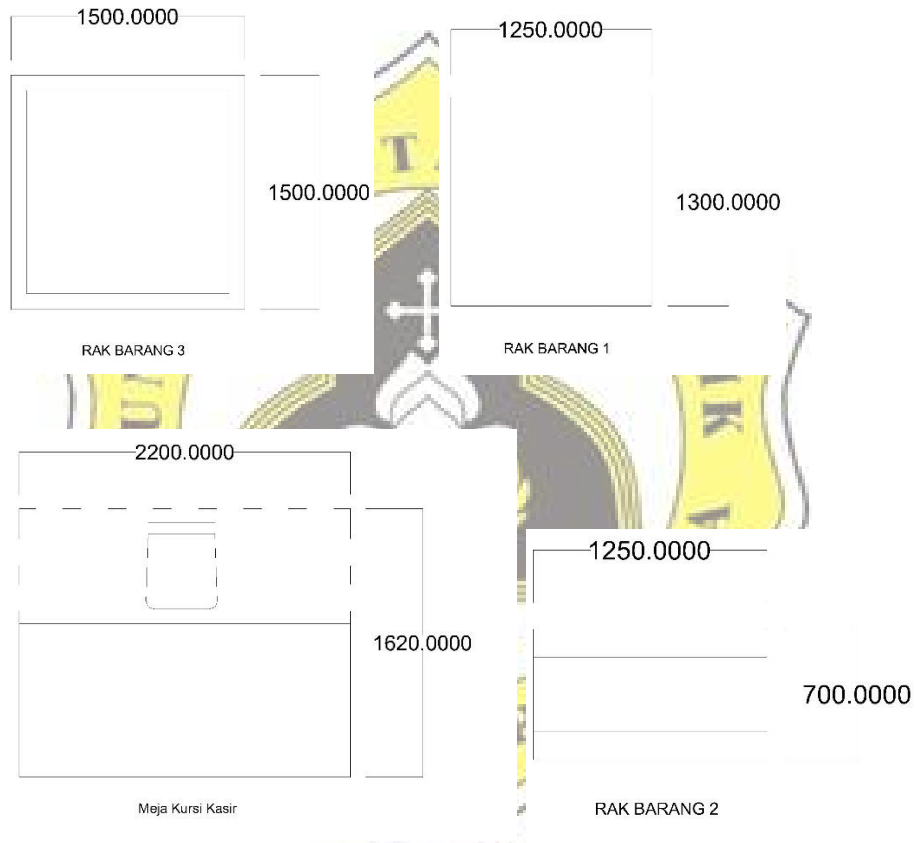

- Kapasitas 90 orang
- Rak barang 1 =  $1.25 \times 1.3 \times 6 = 9.75 \text{ m}^2$
- Rak barang 2 =  $1.25 \times 0.7 \times 6 = 5.25 \text{ m}^2$
- Rak barang 3 =  $1.5 \times 1.5 \times 4 = 9 \text{ m}^2$
- Meja Kasir =  $2,2 \times 1,4 = 3.08 \text{ m}^2$
- Kursi Kasir =  $0,5 \times 0,5 \times 2 = 0,5 \text{ m}^2$

- Tipe hunian Apartemen
  - Kapasitas 4 orang
  - 9 m x 6 m

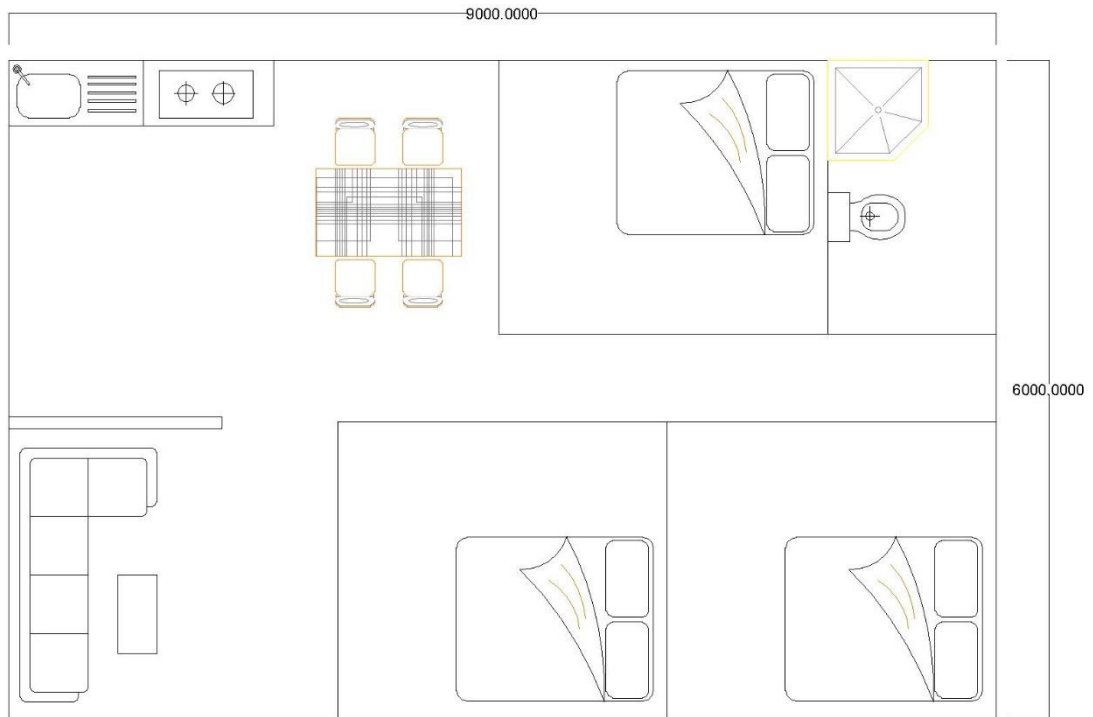

Tipe hunian  
apartemen



Submission author:  
15a10123 WISNU KRISNANDI CAKRA BUANA

Check ID:  
15912648

Check date:  
15.01.2020 03:50:16 GMT+0

Check type:  
Doc vs Internet + Library

Report date:  
15.01.2020 06:28:03 GMT+0

User ID:  
25259



File name: 15.a1.0123\_Wisnu Krisnandi Cakra Buana.docx

File ID: 20210727 Page count: 26 Word count: 10601 Character count: 71221 File size: 120.77 KB

## 6.07% Matches

Highest match: 2.91% with library source. File ID: 6555217

3.17% Internet Matches

54

Page 28

4.93% Library matches

93

Page 28

## 7.86% Quotes

Quotes

24

Page 29

No references found

## 85.9% Exclusions

Sources less than 8 words were automatically excluded

No internet exclusions found

85.9% Library exclusions

1

Page 29

## Replacement

No replaced characters found