

LAMPIRAN

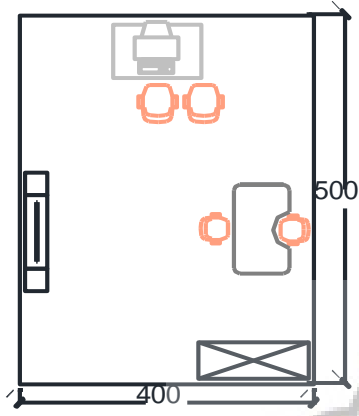

RUANG TERAPI VISUAL

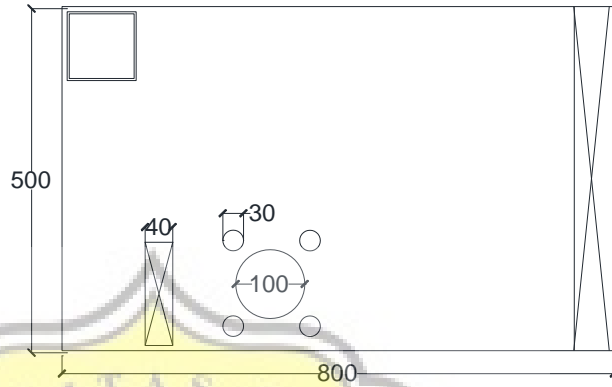

RUANG TERAPI BERMAIN

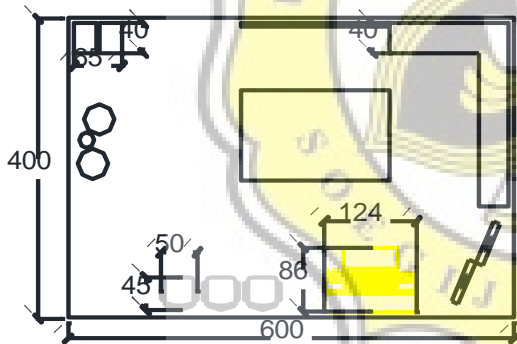

RUANG TERAPI MUSIK

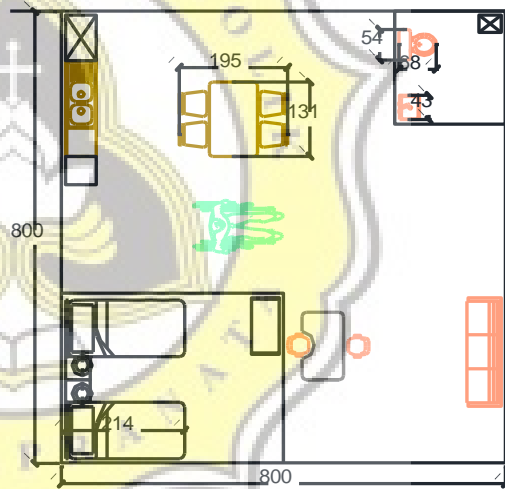

RUANG TERAPI BINA DIRI

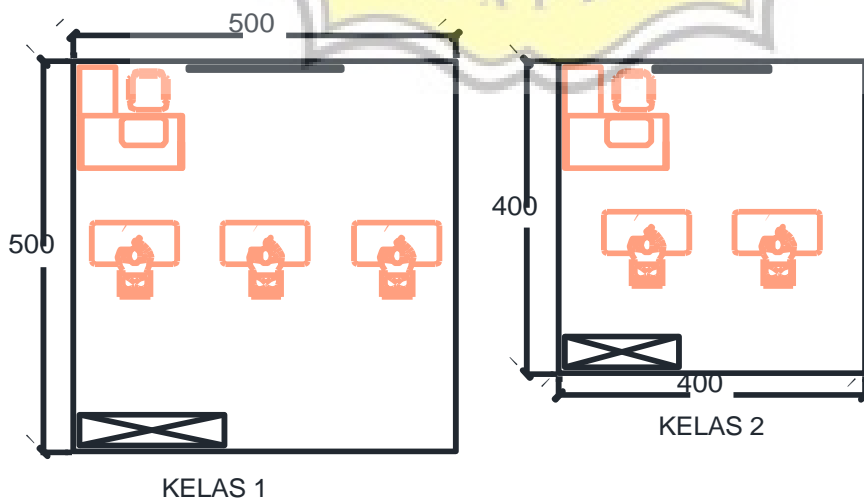
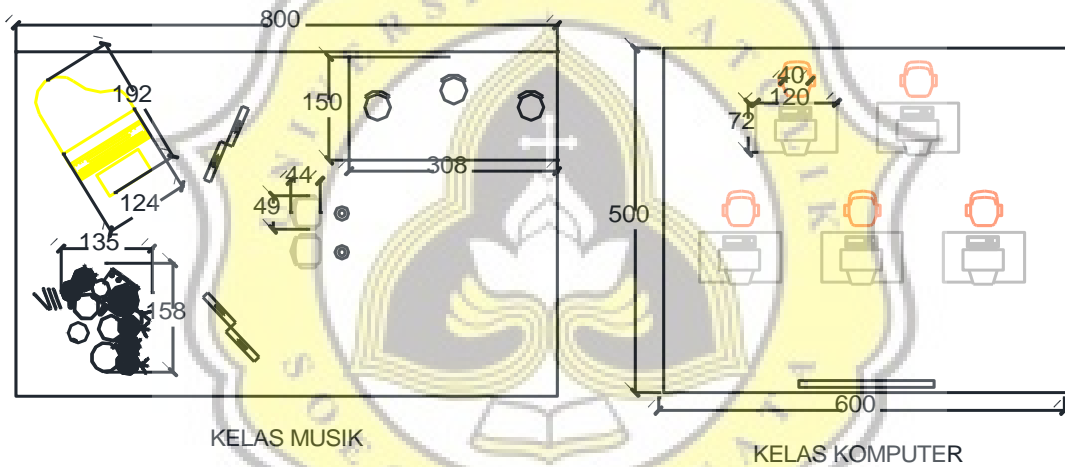
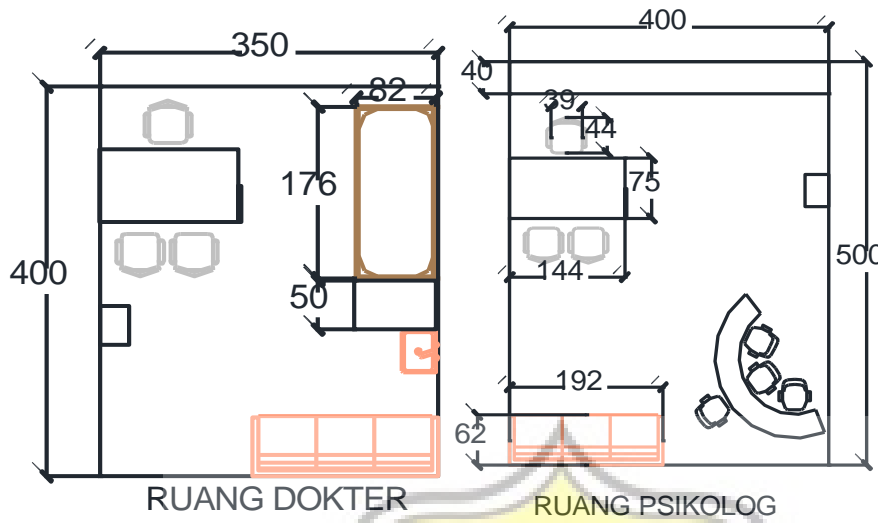

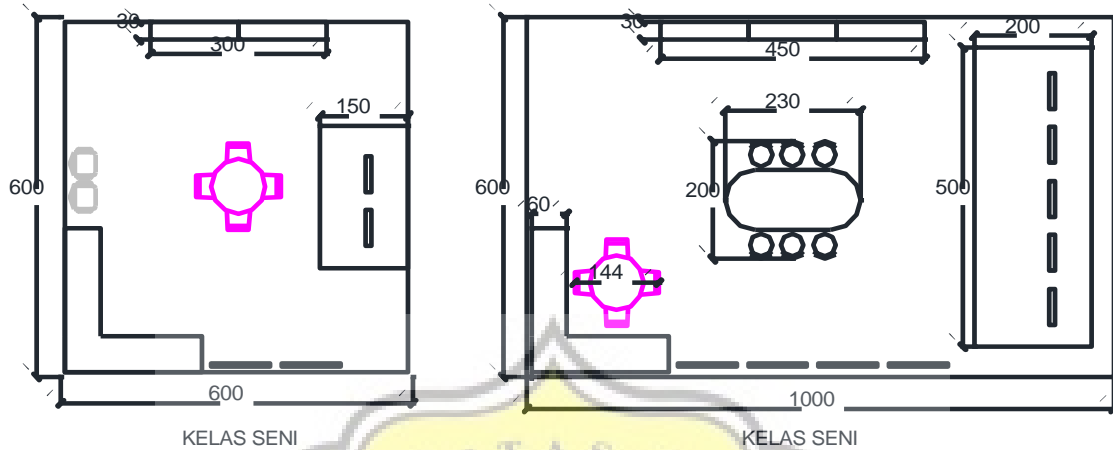

KELAS SENI

KELAS SENI

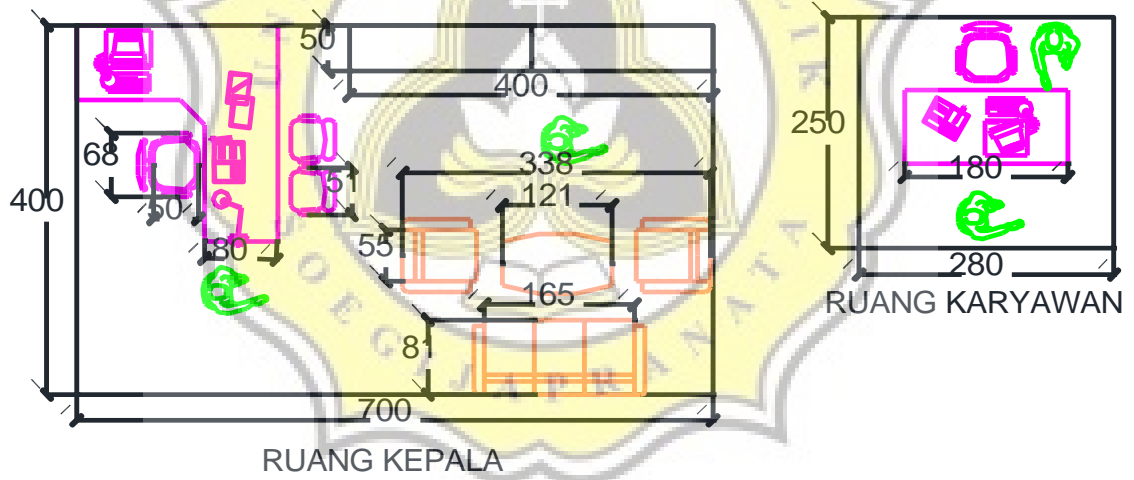

RUANG KEPALA

RUANG KARYAWAN

Filename:
DWITA_PERMATASARI_13.11.0142_Pusat_edukasi_dan_terapi_kesehatan_anak_autis_di_bandun
g.doc

Date: 2017-03-08 12:19 UTC

Results of plagiarism analysis from 2017-03-09 03:22 UTC

528 matches from 100 sources, of which 83 are online sources.

PlagLevel: **6.1%**

- [0] (26 matches, **1.5%**) from your PlagScan document "ANISA_ANGGR..._DIKOTA_KUDUS.doc" dated 2017-03-07
- [1] (28 matches, **0.7%**) from your PlagScan document "Cynthia_Sug...ftar_pustaka.docx" dated 2017-03-07
- [2] (39 matches, **1.2%**) from your PlagScan document "Puput_surya...ftar_pustaka.docx" dated 2017-03-07
(+ 1 documents with identical matches)
- [4] (32 matches, **0.9%**) from your PlagScan document "Mia_Hariyon...n_Pekalongan.docx" dated 2017-03-07
- [5] (24 matches, **0.6%**) from your PlagScan document "ASTRELLA_MA...A_DI_SEMARANG.pdf" dated 2017-03-06
- [6] (27 matches, **0.6%**) from your PlagScan document "R._MARTHIAN...EN_TEMANGGUNG.pdf" dated 2017-03-07
- [7] (2 matches, **0.3%**) from <https://id.answers.yahoo.com/question/index?qid=20091022233608AASvMly>
- [8] (17 matches, **0.4%**) from docplayer.info/29544536-Landasan-teori-d...dayak-kalimantan-timur-di-samarinda.html
- [9] (13 matches, **0.4%**) from docplayer.info/34585219-Landasan-teori-dan-program.html
- [10] (20 matches, **0.4%**) from your PlagScan document "Agustinus_E...re_di_Kendal.docx" dated 2017-03-07
- [11] (13 matches, **0.4%**) from repository.unika.ac.id/4783/1/11.11.0057_AFID_ULIL_AIDI_cover.pdf
- [12] (10 matches, **0.4%**) from docplayer.info/42936159-Landasan-teori-dan-program.html
- [13] (11 matches, **0.3%**) from repository.unika.ac.id/152/1/08.11.0114_Anabila_Soraya_COVER.pdf
- [14] (5 matches, **0.2%**) from <https://id.wikipedia.org/wiki/Bandung>
- [15] (11 matches, **0.3%**) from repository.unika.ac.id/2341/1/09.11.0057_Oki_Oktaviani._E_COVER.pdf
- [16] (3 matches, **0.3%**) from repository.wima.ac.id/256/2/BAB_1.pdf
- [17] (11 matches, **0.2%**) from repository.unika.ac.id/4656/1/10.11.0018_ROMNY_TJANDRA_cover.pdf
- [18] (4 matches, **0.2%**) from menginapdi.com/jawa-barat/kota-bandung/
(+ 1 documents with identical matches)
- [20] (3 matches, **0.2%**) from waterlangga.blogspot.com/2012/03/kota-kota-terbesar-di-asia-tenggara.html
- [21] (2 matches, **0.2%**) from elib.unikom.ac.id/files/disk1/587/jbptunikompp-gdl-mfahmiiska-29301-10-unikom_m-v.pdf
- [22] (3 matches, **0.2%**) from menginapdi.com/
- [23] (3 matches, **0.2%**) from rumahdijual-syariah.com/2016/08/01/bandung/
(+ 1 documents with identical matches)
- [25] (3 matches, **0.2%**) from www.kkpbandung.com/
(+ 10 documents with identical matches)
- [36] (8 matches, **0.2%**) from documents.mx/documents/cover-56477bf48621a.html
- [37] (3 matches, **0.2%**) from dokumen.tips/documents/tugas-56141397c6ec4.html
- [38] (3 matches, **0.2%**) from peta-kota.blogspot.com/2011/05/peta-kota-bandung.html
- [39] (3 matches, **0.2%**) from citec.amikom.ac.id/main/index.php/citec/article/download/22/22
- [40] (9 matches, **0.2%**) from your PlagScan document "Antani_13.1..._Sei_Mangkei.docx" dated 2017-03-07
(+ 1 documents with identical matches)
- [42] (3 matches, **0.1%**) from www.gajiumrumkterbaru.xyz/2016/06/umr-bandung-2016.html
- [43] (5 matches, **0.1%**) from lifestyle.okezone.com/read/2015/04/02/48...312/autisme-di-indonesia-terus-meningkat
(+ 1 documents with identical matches)
- [45] (6 matches, **0.1%**) from documents.tips/documents/dermaga-08110124melynorphaseriholobabipdf.html
- [46] (2 matches, **0.2%**) from averroeza.blogspot.com/
- [47] (1 matches, **0.2%**) from repository.usu.ac.id/bitstream/123456789/26340/5/Chapter_I.pdf

[48] (2 matches, **0.1%**) from <https://bandungdelight.wordpress.com/feed/>
 [49] (2 matches, **0.1%**) from <https://kargologistik.wordpress.com/2016.../jasa-ekspedisi-kirim-barang-ke-bandung/>
 [50] (2 matches, **0.1%**) from <https://sitiidaliah.wordpress.com/>
 [51] (2 matches, **0.1%**) from <https://www.scribd.com/document/327831857/RDTR>
 [52] (1 matches, **0.1%**) from <https://artikelabk.wordpress.com/tag/abk/>
 (+ 1 documents with identical matches)
 [54] (2 matches, **0.1%**) from <https://kelompokungu.wordpress.com/2013/12/04/sejarah-kota-bandung/>
 [55] (2 matches, **0.1%**) from <https://juitacahya07.wordpress.com/2016/...us-bayi-anak-balita-normal-dan-abnormal/>
 [56] (4 matches, **0.1%**) from <repository.usu.ac.id/bitstream/123456789/59221/4/Chapter I.pdf>
 [57] (1 matches, **0.1%**) from skripsi-skripsiun.blogspot.com/2014/09/skripsi-psikologigambaran-kebahagiaan_11.html
 [58] (5 matches, **0.1%**) from <repository.unika.ac.id/254/8/10.11.0058 Yusef Agung Christiawan LAMPIRAN.pdf>
 [59] (2 matches, **0.1%**) from <repository.usu.ac.id/bitstream/123456789/22489/4/Chapter II.pdf>
 [60] (1 matches, **0.1%**) from <https://www.facebook.com/IDRepubliku>
 (+ 3 documents with identical matches)
 [64] (3 matches, **0.1%**) from your PlagScan document "Candra_Sint...ntai_selatan.docx" dated 2016-12-16
 [65] (1 matches, **0.1%**) from <kayukujati.blogspot.com/2014/06/jual-meja-kursi-sekolah-kayu-jati-dan.html>
 [66] (2 matches, **0.1%**) from <www.indobitumen.com/2016/03/apa-itu-atap-bitumen.html>
 (+ 4 documents with identical matches)
 [71] (3 matches, **0.1%**) from <documents.tips/documents/09110100yuanitacpurnaminingsih-bab1.html>
 [72] (1 matches, **0.1%**) from <https://id.scribd.com/doc/297763623/Lampiran-raperda-rtrw-kota-bandung>
 (+ 1 documents with identical matches)
 [74] (1 matches, **0.0%**) from <mejakursisekolahfulljati.blogspot.com/>
 [75] (1 matches, **0.0%**) from <www.jatimebeljepara.net/meja-kursi-kayu/meja-kursi-sekolah-kayu-jati-jepara.htm>
 [76] (1 matches, **0.0%**) from <jualmejakursisekolahkayujati.blogspot.com/>
 [77] (1 matches, **0.0%**) from <www.matrapendidikan.com/2014/06/tips-menata-ruang-kelas.html>
 [78] (1 matches, **0.0%**) from <https://issuu.com/tribunjogja/docs/tribunjogja-10-11-2015/13>
 [79] (1 matches, **0.0%**) from <www.penjualan.web.id/kursi-jati-bekas-jakarta/>
 [80] (3 matches, **0.1%**) from <https://id.answers.yahoo.com/question/index?qid=20100202183930AAe62z9>
 [81] (2 matches, **0.1%**) from <jumridahusni.blogspot.com/2011/07/administrasi-sarana-prasarana.html>
 [82] (1 matches, **0.1%**) from your PlagScan document "Gelar_Prata...Gelar_Pratama.pdf" dated 2017-01-24
 [83] (1 matches, **0.1%**) from <dokumen.tips/documents/makalah-semprof.html>
 [84] (2 matches, **0.1%**) from <documents.tips/documents/autisme-5623ffd259d0b.html>
 [85] (2 matches, **0.0%**) from your PlagScan document "Stefanus_Ro...erhadap_Inov.docx" dated 2017-03-05
 (+ 1 documents with identical matches)
 [87] (2 matches, **0.1%**) from your PlagScan document "Sahazima_Yuta_REVISI_OK.pdf" dated 2017-01-26
 (+ 2 documents with identical matches)
 [90] (1 matches, **0.1%**) from <tempatwisaata.com/daftar-tempat-wisata-di-bandung-yang/>
 [91] (1 matches, **0.1%**) from <news.detik.com/opini-anda/1607282/hari-a...edunia-apa-kabar-sahabat-autis-indonesia>
 [92] (1 matches, **0.0%**) from <teknikspilblog006.blogspot.com/2014/10/pengertian-genteng-beserta-macam-macam.html>
 [93] (2 matches, **0.0%**) from <https://www.slideshare.net/ratihnaini7/k...nterior-ruang-terapi-perilaku-anak-autis>
 [94] (1 matches, **0.0%**) from birobangunan.blogspot.com/2013/07/jenis-jenis-genteng_16.html
 (+ 1 documents with identical matches)
 [96] (1 matches, **0.1%**) from <https://www.scribd.com/doc/56341973/Jurn...ua-Pada-Terapi-Biomedis-Untuk-Anak-Autis>
 [97] (1 matches, **0.0%**) from <edupaint.com/eksterior/teras/981-read-11...ap-bitumen-untuk-hunian-yang-cantik.html>
 (+ 2 documents with identical matches)

Settings

Sensitivity: Medium

Bibliography: Bibliography excluded

Citation detection: Reduce PlagLevel

Whitelist: --

Analyzed document

=====1/194=====

PROJEK AKHIR ARSITEKTUR

Periode LXXI, Semester Genap, Tahun 2016/2017

**LANDASAN TEORI DAN PROGRAM
(BERKAS UNTUK SIDANG)**

**PUSAT EDUKASI DAN TERAPI KESEHATAN
ANAK AUTIS DI BANDUNG**

Tema Desain

Arsitektur Perilaku

Fokus Kajian

Implementasi safety design dengan menyesuaikan perilaku anak autis

Diajukan untuk memenuhi sebagai persyaratan



FORMULIR SCAN ANTI PLAGIARISME 6,4% &

Nama : DWITA PERMATASARI

Alamat email : duitasan64@gmail.com

Fak. / Prodi : FAD / ARSITEKTUR NIM : 13.11.0142

berupa (TESIS, TUGAS AKHIR, SKRIPSI, SUMMARY, LAPORAN KERJA PRAKTEK)

dengan judul : PUSAT EDUKASI DAN TERAPI KESEHATAN ANAK AUTIS
DI BANDUNG

Semarang, 9 MARET 2017

Petugas, _____ Meng Serahkan, Dosen Pembimbing,

_____ DWITA P. _____
IR. IM. TRI HESTI M, MT.

NB. Laporan hasil scan terlampir **PERLU DITANDA TANGAN** untuk Yang bersangkutan *

