

1. Produk- produk Great Wall

Cowry

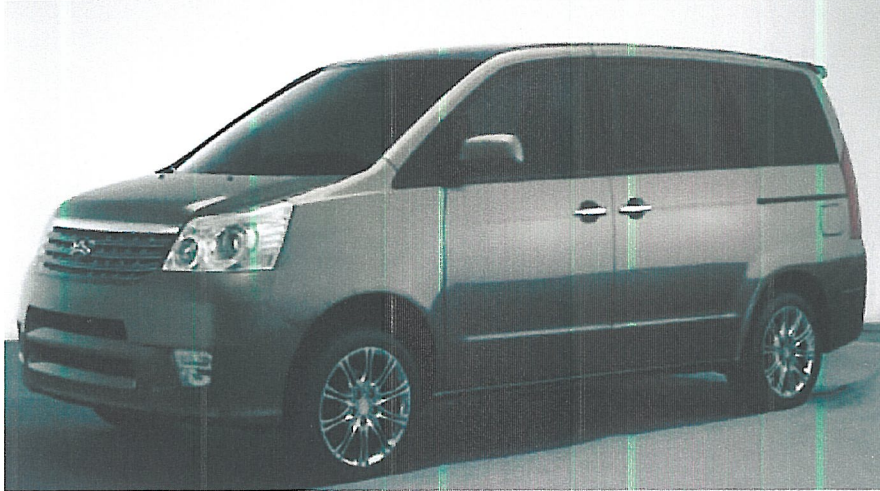

Cowry

| Model | CC6460VM00 |
|---------------------------|---|
| Type | Gasoline |
| Engine Model | Mitsubishi 4G63S4N |
| Displacement (ml) | 1997 |
| Max. power (Kw/r/min) | 105/6000 |
| Max. Torque (N*m/r/min) | 185/(3000-4500) |
| Emission standard | Euro IV |
| Dimension L/W/H (mm) | 4574×1740×1845 |
| Wheel base (mm) | 2825 |
| Track (front/rear) (mm) | 1480/1466 |
| Min. ground clearance(mm) | 108 |
| Kerb mass (kg) | 1510 |
| Drive mode | Front position front drive |
| Brake system (front/rear) | Front disc, rear drum |
| Steering gear | Rack and pinion, hydraulic power steering |
| Gear box | 5 speed manual |
| Max. speed(km/h) | 170 |
| Front suspension | Mcpherson Independent Suspension |
| Rear suspension | Trailing arm torsion beam compound suspension |

Because of the amelioration of technology, the above specification is likely to change, please depend on the detailed specification provided by sale department.

Deer

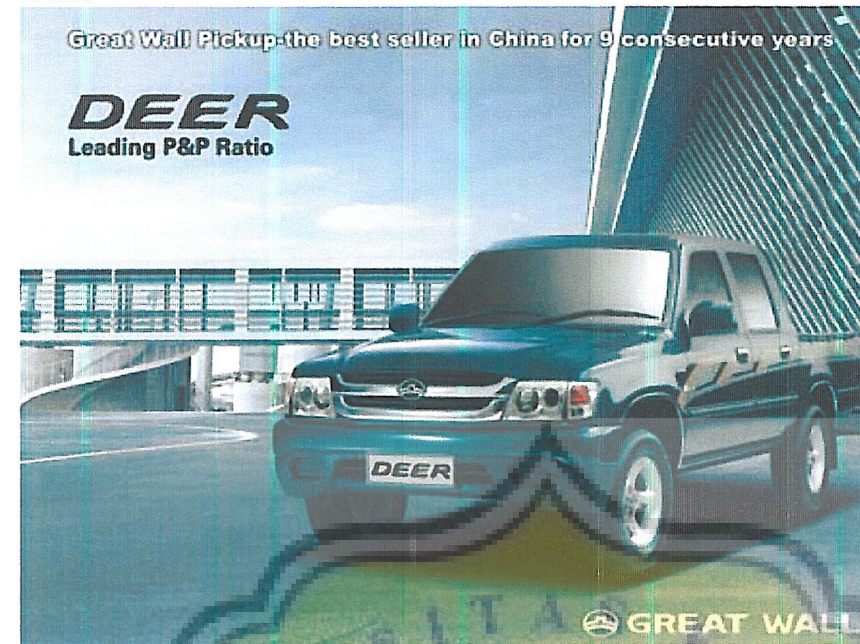

Technical Parameters

| Model | CC1021AR |
|---|---|
| Dimensions (L × W × H)(mm) | 5305×1740, 1705×1670 |
| Cargo-body Inner Dimensions (L × W × H)(mm) | 1865 × 1465 × 405 |
| Payload(kg) | 500 |
| Total Mass (kg) | 2245 |
| Complete Vehicle Kerb Mass(kg) | 1420 |
| Max Speed (km/h) | ≥120/130 |
| Type of drive | Rear wheel drive |
| Track (front/rear) (mm) | 1450/1430 |
| Wheel base (mm) | 3380 |
| Front suspension | Double cross-arms type, independent suspension with torsion bar springs |
| Rear suspension | Variable-rate, unsymmetrical leaf spring suspension |
| Front Suspension/Rear Suspension (mm) | 825/1100 |
| Brake mode | Two-circuit hydro-vacuum brake |
| Brake (front/rear) | Disc brake/drum brake |
| Gear | 5 forward gear, 1 reverse gear |
| Tyre | 215/75R15 |
| Passengers (front/rear) | 2/3 |
| Engine | 491QE |

Medium double

| Model | CC1021LSR |
|---|---|
| Dimension L/W/H(mm) | 5130 × 1740, 1705 × 1670 |
| Cargo-body Inner Dimensions (L × W × H)(mm) | 1600 × 1460 × 405 |
| Payload(kg) | 500 |
| Total Mass (kg) | 2225 |
| Complete Vehicle Kerb Mass(kg) | 1400 |
| Max Speed(km/h) | ≥120/130 |
| Drive Type | 2WD |
| Track (front/rear) (mm) | 1450/1430 |
| Wheel base (mm) | 3085 |
| Front suspension | Double cross-arms type, independent suspension with torsion bar springs |
| Rear suspension | Variable-rate, unsymmetrical leaf spring suspension |
| Front Suspension/Rear Suspension (mm) | 825/1220 |
| Brake mode | Two-circuit hydro-vacuum brake |
| Brake (front/rear) | Disc brake/drum brake |
| Gear | 5 forward gear, 1 reverse gear |
| Tyre | 215/75R15 |
| Passengers (front/rear) | 2/3 |
| Engine | 491QE Ele-fuel Injection type |

Standart double

| Model | CC1022SR |
|---|---|
| Dimensions (L × W × H)(mm) | 4895×1740, 1705×1670 |
| Cargo-body Inner Dimensions (L × W × H)(mm) | 1405×1465×405 |
| Payload(kg) | 500 |
| Total Mass (kg) | 2215 |
| Complete Vehicle Kerb Mass(kg) | 1390 |
| Max Speed (km/h) | ≥120/130 |
| Drive Type | 2WD |
| Track (front/rear) (mm) | 1450/1430 |
| Wheel base (mm) | 2850 |
| Front suspension | Double cross-arms type, independent suspension with torsion bar springs |

| | |
|---------------------------------------|---|
| Rear suspension | Variable-rate, unsymmetrical leaf spring suspension |
| Front Suspension/Rear Suspension (mm) | 825/1100 |
| Brake mode | Two-circuit hydro-vacuum brake |
| Brake (front/rear) | Disc brake/drum brake |
| Gear | 5 forward gear, 1 reverse gear |
| Tyre | 215/75R15 |
| Passengers (front/rear) | 2/3 |
| Engine | 491QE Ele-fuel Injection Type |

One and half

| Technical Parameters | |
|---|---|
| Model | CC1021LR |
| Dimension L/W/H(mm) | 5130 × 1740,1705 × 1670 |
| Cargo-body Inner Dimensions (L×W×H)(mm) | 1865 × 1465 × 405 |
| Payload(kg) | 500 |
| Total Mass (kg) | 2100 |
| Complete Vehicle Kerb Mass(kg) | 1340 |
| Max Speed(km/h) | ≥120/130 |
| Type of drive | Rear wheels drive |
| Track (front/rear) (mm) | 1450/1430 |
| Wheel base (mm) | 3085 |
| Front suspension | Double cross-arms type, independent suspension with torsion bar springs |
| Rear suspension | Variable-rate, unsymmetrical leaf spring suspension |
| Front Suspension/Rear Suspension (mm) | 825/1220 |
| Brake mode | Two-circuit hydro-vacuum brake |
| Brake (front/rear) | Disc brake/drum brake |
| Gear | 5 forward gear,1 reverse gear |
| Tyre | 215/75R15 |
| Passengers (front/rear) | 2/3 |
| Engine | 491QE Ele-fuel Injection type |

Because of the amelioration of technology, the above specification is likely to change, please depend on the detailed specification provided by sale department

Extra long single

| Technical Parameters | |
|---|---|
| Model | CC1021CR |
| Dimension L/W/H(mm) | 4945 × 1740,1705 × 1670 |
| Cargo-body Inner Dimensions (L × W × H)(mm) | 2260 × 1465 × 405 |
| Payload(kg) | 500 |
| Total Mass (kg) | 1945 |
| Complete Vehicle Kerb Mass(kg) | 1315 |
| Max Speed(km/h) | ≥120/130 |
| Drive Type | Rear wheels drive |
| Track (front/rear) (mm) | 1450/1430 |
| Wheel base (mm) | 2960 |
| Front suspension | Double cross-arms type, independent suspension with torsion bar springs |
| Rear suspension | Variable-rate, unsymmetrical leaf spring suspension |
| Front Suspension/Rear Suspension (mm) | 825/1160 |
| Brake mode | Two-circuit hydro-vacuum brake |
| Brake (front/rear) | Disc brake/drum brake |
| Gear | 5 forward gear,1 reverse gear |
| Tyre | 215/75R15 |
| Passengers | 2 |
| Engine | 491QE Ele-fuel Injection type |

Peri



| Technical Parameters | |
|----------------------------------|---|
| Model | CC7130MM02 |
| Type | Gasoline |
| Engine | GW413EF engine |
| Dimension L/W/H(mm) | 3548×1580×1544/1531 (with luggage rack) |
| Wheelbase (mm) | 2299 |
| Tyre | 165/70 R14 |
| Kerb mass (kg) | 1015 |
| Luggage-compartment capacity (L) | 206/860 (back row seat folding) |
| Engine type | 4 DOHC 16V |
| Displacement(ml) | 1342 |
| Max. power(Kw/r/min) | 65/6000 |
| Max. torque(Nm/r/min) | 115/4200-5200 |
| Max. speed(km/h) | ≥160 |
| 0-100km/h accelerating time(S) | ≤15 |

Because of the amelioration of technology, the above specification is likely to change, please depend on the detailed specification provided by sale department.

Lampiran

| | | |
|-------------------------|---|---|
| Brake mode | Two-circuit hydro-vacuum brake | Two-circuit hydro-vacuum brake |
| Brake (front/rear) | Disc brake/drum brake | Disc brake/drum brake |
| Gear | 5 forward gear, 1 reverse gear | 5 forward gear, 1 reverse gear |
| Tyre | 235/75R15, or 235/70R16 | 235/70R16 |
| Passengers (front/rear) | 2/3 | 2/3 |
| Engine | 491QE Multi-point Ele-fuel injection engine | 491QE Multi-point Ele-fuel injection engine |

Hover.



Pegasus.



Safe.



Technical Parameters

| Model | Gasoline | Diesel |
|----------------------------------|--|--|
| Engine | Mitsubishi 4G 64 16V 4 cylinder in line | GW2.8TC |
| Fuel type | ≥93# unleaded gasoline | light diesel oil |
| Displacement(L) | 2.4L | 2.8L |
| Compressive ratio | 9.5:1 | 17.2:1 |
| Transmission box | 5-gear manual transmission | 5-gear manual transmission |
| Steering gear system | Gear rack integral Power steering | Gear rack integral Power steering |
| Front suspension | Double fork-arms type, independent suspension with torsion bar springs | Double fork-arms type, independent suspension with torsion bar springs |
| Rear suspension | 4-link coil spring dependent suspension | 4-link coil spring dependent suspension |
| Brake system | Two-circuit hydro-vacuum brake, front and rear disc brake | Two-circuit hydro-vacuum brake, front and rear disc brake |
| Tank volume(L) | 74 | 74 |
| Min. ground clearance(mm) | 200 | 200 |
| Max. grade ability not less than | 40% | 40% |
| Approach angle/Departure | 28°/27.5° | 29°/27.5° |

Technical Parameters

| Model | CC6481B1-3 | CC6481BY1-3 |
|--------------------------------|---|---|
| Dimensions (L x W x H)(mm) | 4810, 4820, 4885 x 1700, 1800, 1835 x 1835, 1855, 1895 | 4810, 4860 x 1825 x 1885, 1865 |
| Total Mass (kg) | 1950, 1990 | 2085 |
| Complete Vehicle Kerb Mass(kg) | 1625, 1665 | 1760 |
| Max Speed (km/h) | ≥130 | ≥130 |
| Drive Type | Rear wheel drive | Four wheel drive |
| Track (front/rear) (mm) | 1465, 1515/1485, 1520 | 1515/1520 |
| Wheel base (mm) | 2760 | 2760 |
| Approach angle(°) | 29, 31 | 31 |
| Departure angle(°) | 27, 23 | 23 |
| Front suspension | Double cross-arms type, independent suspension with torsion bar springs | Double cross-arms type, independent suspension with torsion bar springs |
| Rear suspension | Variable-rate, unsymmetrical leaf spring suspension | Variable-rate, unsymmetrical leaf spring suspension |

Technical Parameters

| Model | CC6460D (2WD) | CC6460DY (4WD) |
|--------------------------------|--|----------------|
| Dimensions (L x W x H)(mm) | 4860/4795/4625/4560 x 1725/1780/1755 x 1820/1770 | |
| Total Mass (kg) | 1965 | 2085 |
| Complete Vehicle Kerb Mass(kg) | 1665 | 1760 |
| Max Speed (km/h) | ≥130 | ≥130 |
| Drive Type | Rear wheel drive | 4-wheels drive |
| Track (front/rear) (mm) | 1480, 1515/1470, 1520 | |
| Wheel base (mm) | 2615 | 2615 |
| Min Ground Clearance | 200 | 200 |

| | | |
|-------------------------|---|---|
| Approach angle(°) | 48 | 48 |
| Departure angle(°) | 22 | 22 |
| Front suspension | Double cross-arms type, independent suspension with torsion bar springs | Double cross-arms type, independent suspension with torsion bar springs |
| Rear suspension | Coil springs | Coil springs |
| Brake mode | Four-wheel disc brake | Four-wheel disc brake |
| Gear | 5 forward gear, 1 reverse gear | 5 forward gear, 1 reverse gear |
| Tyre | 235/75R15 | 235/75R15 |
| Passengers (front/rear) | 2/3 | 2/3 |
| Engine | 491QE Multi-point Ele-fuel injection engine | 491QE Multi-point Ele-fuel injection engine |

| | | |
|----------------------|---------|---------|
| Displacement(ml) | 2237 | 2771 |
| Max.power (kw/r/min) | 78/4600 | 57/3600 |

| | | |
|------|--------------------------------|----------------------|
| Gear | 5 forward gear, 1 reverse gear | |
| Tyre | 235/75R15,P235/70R16 | 235/75R15,P235/75R16 |

Sing.



Socool.



Sailor.



Technical Parameters

| Model | CC6510S1 | CC6510SC1 | CC6510SY1 |
|--------------------------------|---|----------------------------|--------------------------|
| Engine type | 491QE ele-fuel injection | GW4D28TDI diesel | 491QE ele-fuel injection |
| Dimensions (L x W x H)(mm) | 5105/5160 x1785/1845 x1870/1905 | 5105/5160 x1785 x1870/1905 | 5165 x1785 x1890 |
| Fuel type | Gasoline | Diesel | Gasoline |
| Total Mass (kg) | 1995,2140,2105,2235 | 2230 | 2105, 2235 |
| Complete Vehicle Kerb Mass(kg) | 1670,1780 | 1760 | 1780 |
| Max Speed (km/h) | ≥120,130 | ≥120,130 | ≥120,130 |
| Track (front/rear) (mm) | 1450/1430 | | |
| Wheel base (mm) | 3025 | | |
| Front suspension | Double cross-arms type, independent suspension with torsion bar springs | | |
| Rear suspension | Variable-rate, unsymmetrical leaf spring suspension | | |
| Brake mode | Two-circuit hydro-vacuum brake | | |
| Brake (front/rear) | Disc brake/drum brake | | |

Technical Parameters

| Model | CC1026SE |
|---|---|
| Type | Gasoline type |
| Dimensions (L x W x H)(mm) | 5095 x 1725 x 1710,1730,1735,1755 |
| Cargo-body Inner Dimensions (L x W x H)(mm) | 1475 x 1440 x 480 |
| Fuel consumption(L/100km) | 7.9 |
| Payload(kg) | 500 |
| Total Mass (kg) | 2325 |
| Complete Vehicle Kerb Mass(kg) | 1500 |
| Max Speed (km/h) | ≥120/130 |
| Drive Type | Rear wheel drive |
| Track (front/rear) (mm) | 1430/1420 |
| Wheel base (mm) | 3025 |
| Front suspension | Double cross-arms type, independent suspension with torsion bar springs |
| Rear suspension | Variable-rate, unsymmetrical leaf spring suspension |
| Brake mode | Two-circuit hydro-vacuum brake |
| Brake (front/rear) | Disc brake/drum brake |
| Gear | 5 forward gear, 1 reverse gear |
| Tyre | P235/70R16 , P215/75R15 |
| Passengers (front/rear) | 2/3 |
| Engine | 491QE Ele-fuel injection |

Technical Parameters

| Type | Gasoline | Diesel |
|--------------------------------|----------------|----------------|
| Engine type | 491QE engine | GW4D28 |
| Dimensions (L x W x H)(mm) | 5150x1670x1705 | 5150x1670x1705 |
| Track(front/rear)(mm) | 1430/1420 | 1430/1420 |
| Wheelbase(mm) | 3025 | 3025 |
| Seating capacity(person) | 2 | 2 |
| Loading capacity(kg) | 480 | 480 |
| Complete vehicle kerb mass(kg) | 1410(800/610) | 1505(895/610) |
| Max. speed(km/h) | 130 | 120 |
| Front/rear suspension | 845/1280 | 845/1280 |

Wingle.



Technical Parameters

| Model | CC1031PS40 | CC1031PS60 |
|---|--|------------|
| Dimensions (L x W x H)(mm) | 5040×1800×1730 | |
| Cargo-body Inner Dimensions (L x W x H)(mm) | 1380×1460×480 | |
| Complete Vehicle Kerb Mass(kg) | 1740 | 1860 |
| Rated load capacity (kg) | 480 | |
| Wheel base (mm) | 3050 | |
| Passengers | 5 | |
| Max speed(km/h) | ≥140 | |
| Engine | GW2.8TC diesel engine | |
| Engine type | 4 cylinder in line,4 strokes,water-cooling,OHC,TDI diesel engine | |
| Displacement(L) | 2.771 | |
| Rated power/rotate speed (Kw/rpm) | 70±3/3600 | |
| Max torque/rotate speed(N•m/rpm) | 225±5/1600~2600 | |
| Min. turning diameter(m) | ≤13 | |
| Min. ground clearance(mm) | 194 | |
| Max.grade ability(%) | ≥30 | |
| Tyre | P235/70R16,235/70R16(optional) | |

Because of the amelioration of technology, the above specification is likely to change, please depend on the detailed specification provided by sale department.

2. Studi ruang.

Mushola

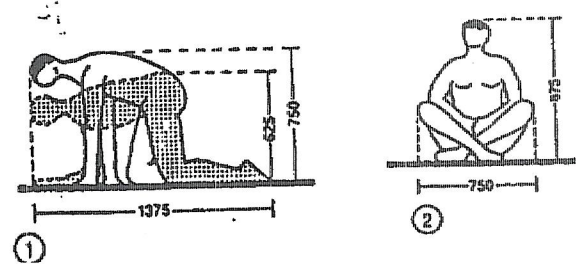

Sumber : Neufret, Ernest, *Data Arsitektur*
 Dimensi 1 orang melakukana sholat
 = 1.35 X 0.7 = 1.03 m²/ orang

Pantry

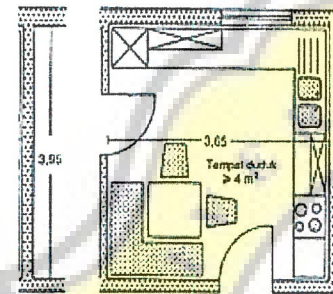

Sumber : Neufret, Ernest, *Data Arsitektur*
 Dapur = 3.65 X 3.95 = 14.417 m²/ unit

Ruang rapat

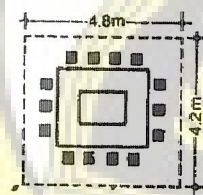

Sumber : Neufret, Ernest, *Data Arsitektur*
 R. Rapat = 5.00 X 4.00 = 20.00m²/ unit

Ruang Administrasi

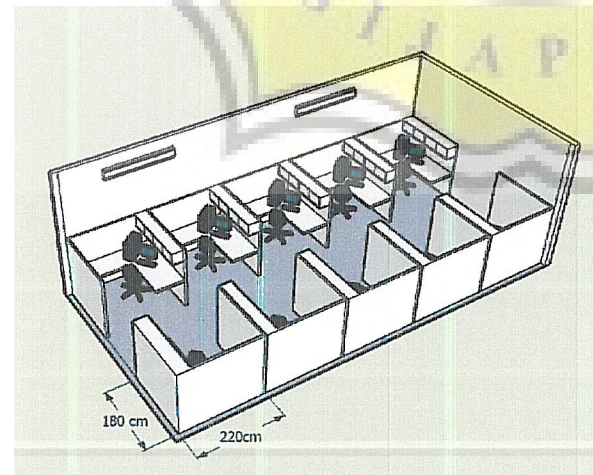

Sumber : Neufret, Ernest, *Data Arsitektur*
 Ruang Administrasi = 1,80 X 2,20 = 3,96 m²/ unit

Ruang Supervisor.

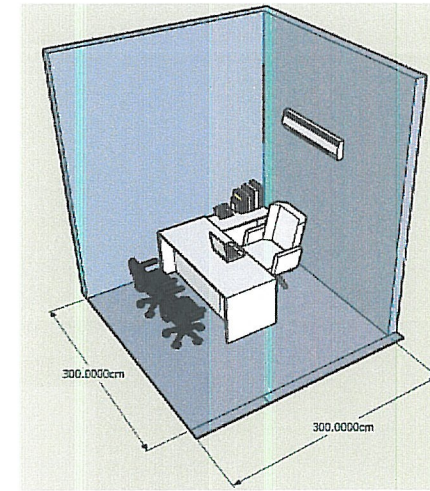

Sumber : Neufret, Ernest, *Data Arsitektur*
 Ruang Supervisor
 = 3,00x3,00 = 9 m²/ unit

Ruang Kepala Cabang.

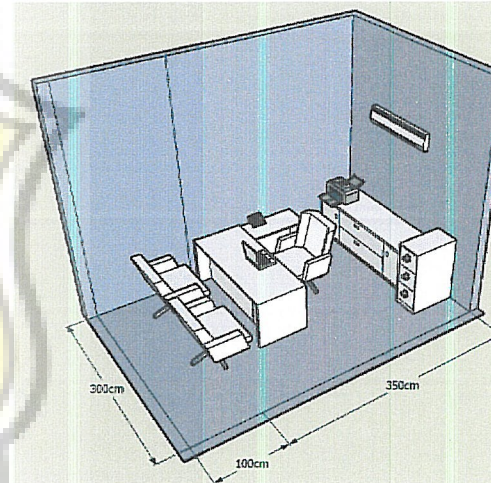

Sumber : Neufret, Ernest, *Data Arsitektur*
 Ruang Kepala Cabang
 = 3,00x4,50 = 13,5 m²/ unit

Ruang Sales

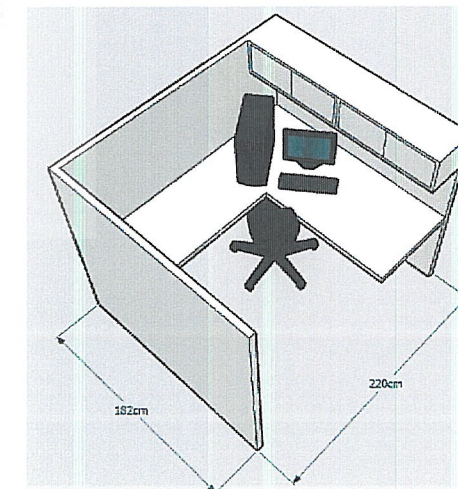

Sumber : Neufret, Ernest, *Data Arsitektur*
 Ruang Sales
 = 1,80 X 2,20 = 3,96 m²/ unit



Ruang Toilet.

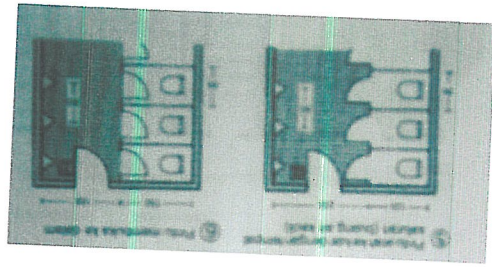

Sumber : Neufret, Ernest,
Data Arsitektur
Toilet
= 2,90 X 3,15 = 9,135 m²/ unit

Service Advisor Area.

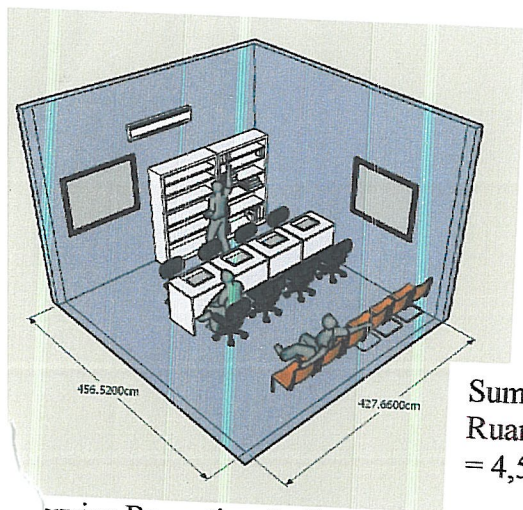

Sumber : Studi Ruang
Ruang Service Advisor
= 4,56 x 4,27 = 19,47 m²/ unit

Service Reception Stall

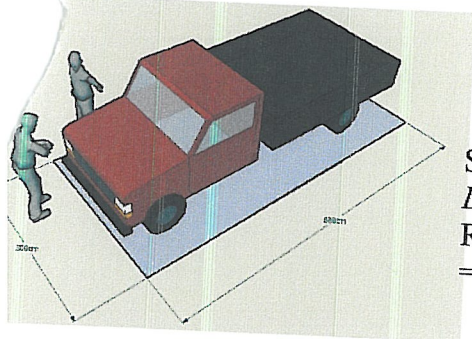

Sumber : Neufret, Ernest,
Data Arsitektur
Ruang Service Reception Stall
= 3,00x6,00 = 18 m²/ unit

Bengkel General Repair

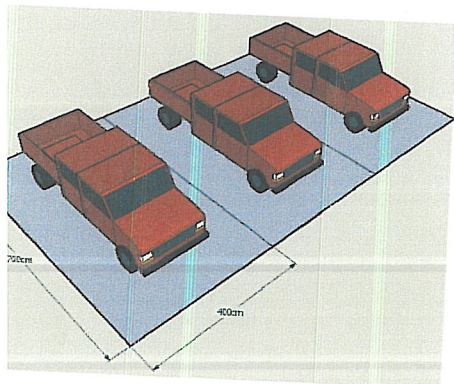

Sumber : Neufret, Ernest,
Data Arsitektur
Ruang General Repair
= 4,00 x 7,00 = 28 m²/ unit

Washing Stall

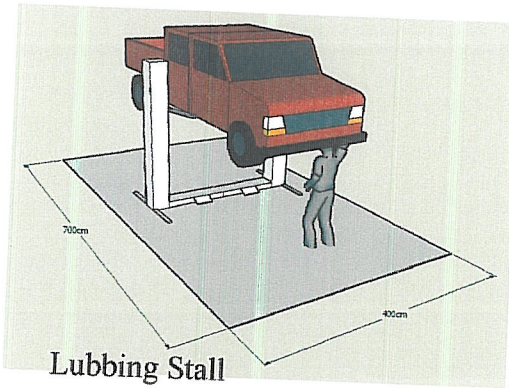

Sumber : Neufret, Ernest,
Data Arsitektur
Ruang Washing Stall
= 4,00 x 7,00 = 28 m²/ unit

Lubbing Stall

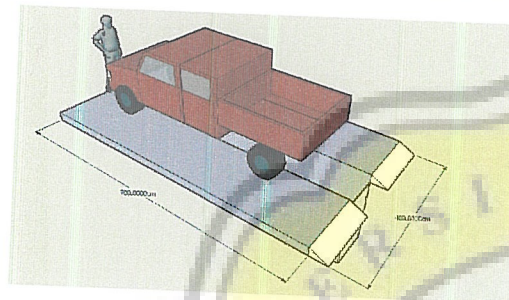

Sumber : Neufret, Ernest,
Data Arsitektur
Ruang Lubbing Stall
= 4,00 x 7,00 = 28 m²/ unit

Café

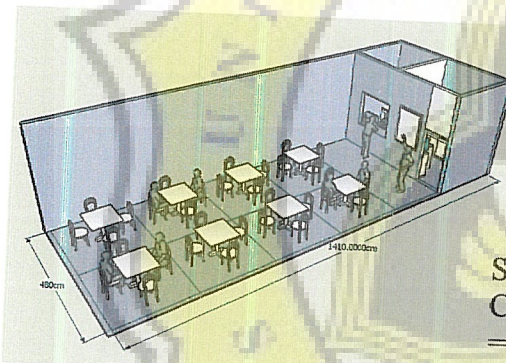

Sumber : Studi Ruang Gerak
Cafe
= 4,8 x 14,10 = 67,68m²/ unit

Stage pameran

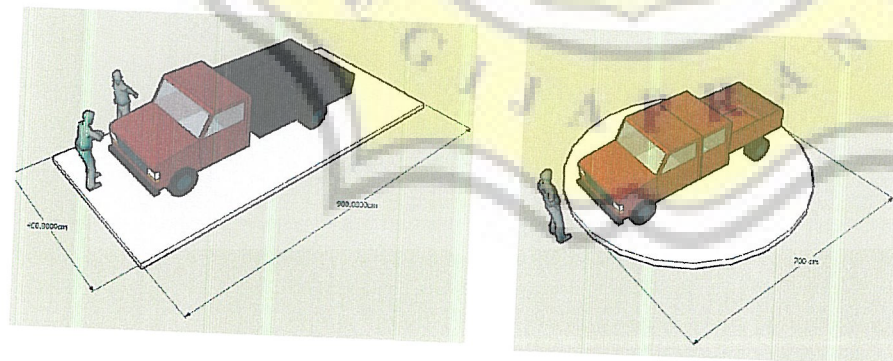

Sumber : Studi Ruang Gerak
Stage Diagonal
= 4,00 x 9,00 = 36 m²/ unit

Sumber : Studi Ruang Gerak
Stage Diagonal
= 3,14 x 7 x 7 = 153 m²/ unit

Costumer Lounge

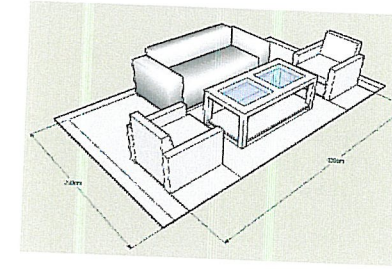

Sumber : Studi Ruang Gerak
Cotumer Lounge
= 2,50 x 4,00= 10 m²/ unit

Lampiran