

# LAMPIRAN

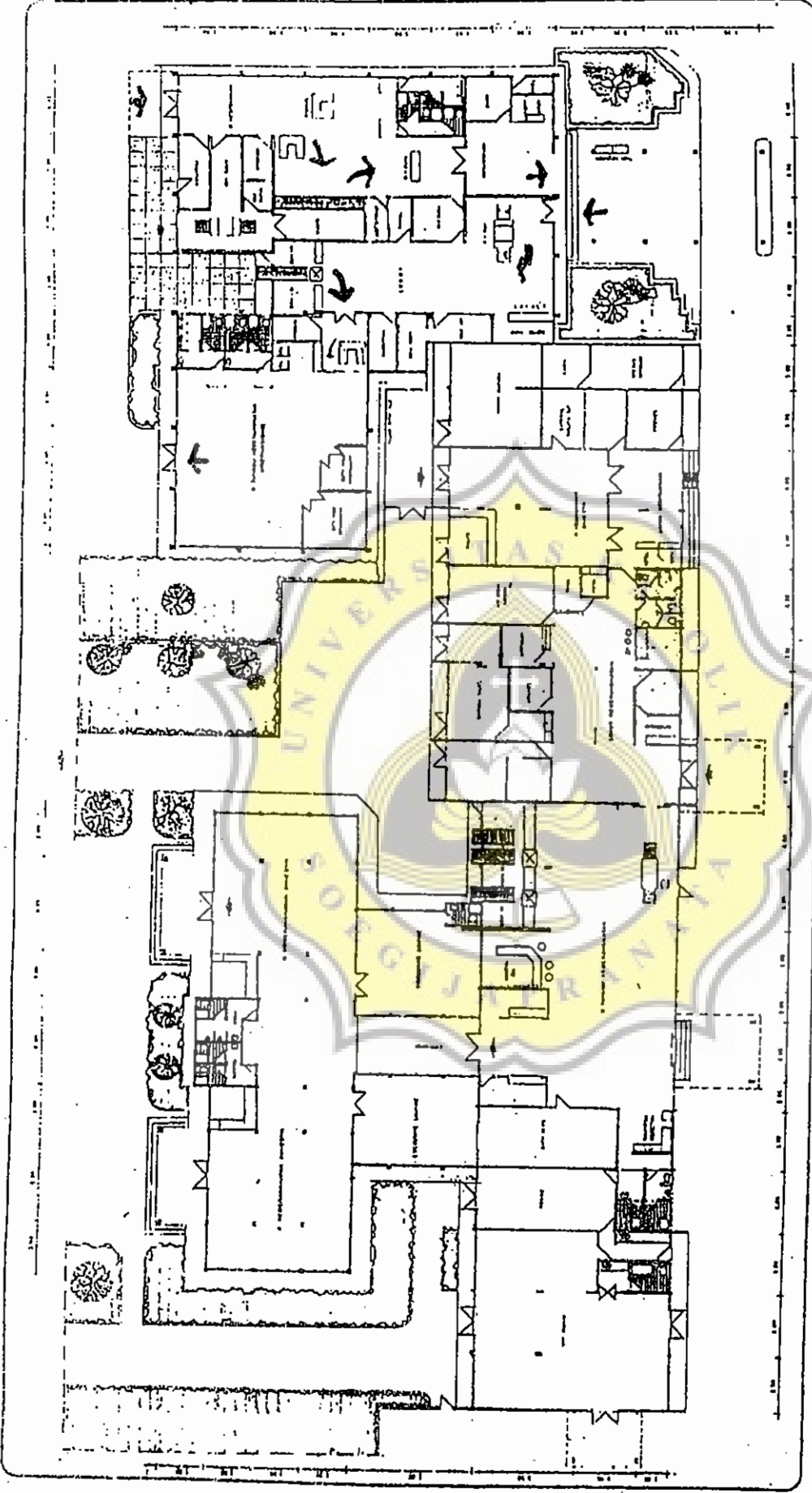

REVISIONS	
NO.	DESCRIPTION
1	ISSUED FOR PERMITTING
2	ISSUED FOR PERMITTING
3	ISSUED FOR PERMITTING
4	ISSUED FOR PERMITTING
5	ISSUED FOR PERMITTING
6	ISSUED FOR PERMITTING
7	ISSUED FOR PERMITTING
8	ISSUED FOR PERMITTING
9	ISSUED FOR PERMITTING
10	ISSUED FOR PERMITTING



REVISIONS	
NO.	DESCRIPTION
1	ISSUED FOR PERMITTING
2	ISSUED FOR PERMITTING
3	ISSUED FOR PERMITTING
4	ISSUED FOR PERMITTING
5	ISSUED FOR PERMITTING
6	ISSUED FOR PERMITTING
7	ISSUED FOR PERMITTING
8	ISSUED FOR PERMITTING
9	ISSUED FOR PERMITTING
10	ISSUED FOR PERMITTING

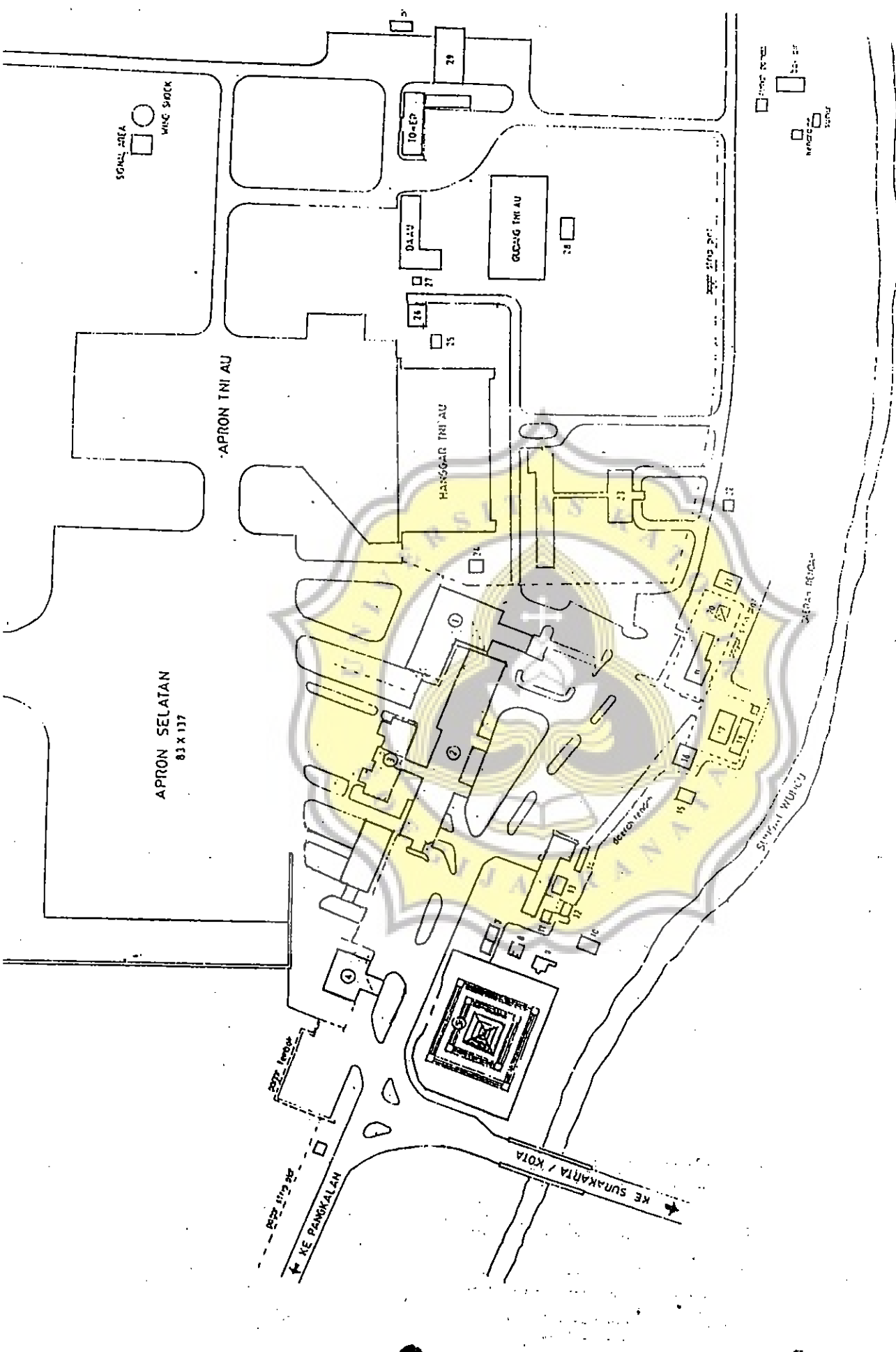

# Regression

## Descriptive Statistics

	Mean	Std. Deviation	N
Penumpang Domestik	202451.38	53403.2463	8
Jumlah wisatawan	3215236.0	250177.5163	8
PDRB	39173001	3452888.9319	8
Income Perkapita	1130992.7	98645.4462	8

## Correlations

		Penumpang Domestik	Jumlah wisatawan	PDRB	Income Perkapita
Pearson Correlation	Penumpang Domestik	1.000	.946	-.064	.021
	Jumlah wisatawan	.946	1.000	-.054	.079
	PDRB	-.064	-.054	1.000	.967
	Income Perkapita	.021	.079	.967	1.000
Sig. (1-tailed)	Penumpang Domestik	.	.000	.440	.480
	Jumlah wisatawan	.000	.	.449	.426
	PDRB	.440	.449	.	.000
	Income Perkapita	.480	.426	.000	.
N	Penumpang Domestik	8	8	8	8
	Jumlah wisatawan	8	8	8	8
	PDRB	8	8	8	8
	Income Perkapita	8	8	8	8

## Variables Entered/Removed<sup>b</sup>

Model	Variables Entered	Variables Removed	Method
1	Income Perkapita, Jumlah wisatawan, PDRB		Enter

- a. All requested variables entered.  
 b. Dependent Variable: Penumpang Domestik

## Model Summary

Model	R	R Square	Adjusted R Square	Std. Error of the Estimate
1	.965 <sup>a</sup>	.932	.880	18466.0098

## Model Summary

Model	Change Statistics				
	R Square Change	F Change	df1	df2	Sig. F Change
1	.932	18.182	3	4	.009

- a. Predictors: (Constant), Income Perkapita, Jumlah wisatawan, PDRB

**ANOVA<sup>b</sup>**

Model		Sum of Squares	df	Mean Square	F	Sig.
1	Regression	1.86E+10	3	6199790979.5	18.182	.009 <sup>a</sup>
	Residual	1.36E+09	4	340993517.37		
	Total	2.00E+10	7			

a. Predictors: (Constant), Income Perkapita, Jumlah wisatawan, PDRB

b. Dependent Variable: Penumpang Domestik

**Coefficients<sup>a</sup>**

Model		Unstandardized Coefficients		Standardized Coefficients	t	Sig.
		B	Std. Error	Beta		
1	(Constant)	-499888.7	130053.03		-3.844	.018
	Jumlah wisatawan	.227	.033	1.063	6.929	.002
	PDRB	1.318E-02	.009	.852	1.415	.230
	Income Perkapita	-.480	.327	-.887	-1.471	.215

a. Dependent Variable: Penumpang Domestik

**Charts**

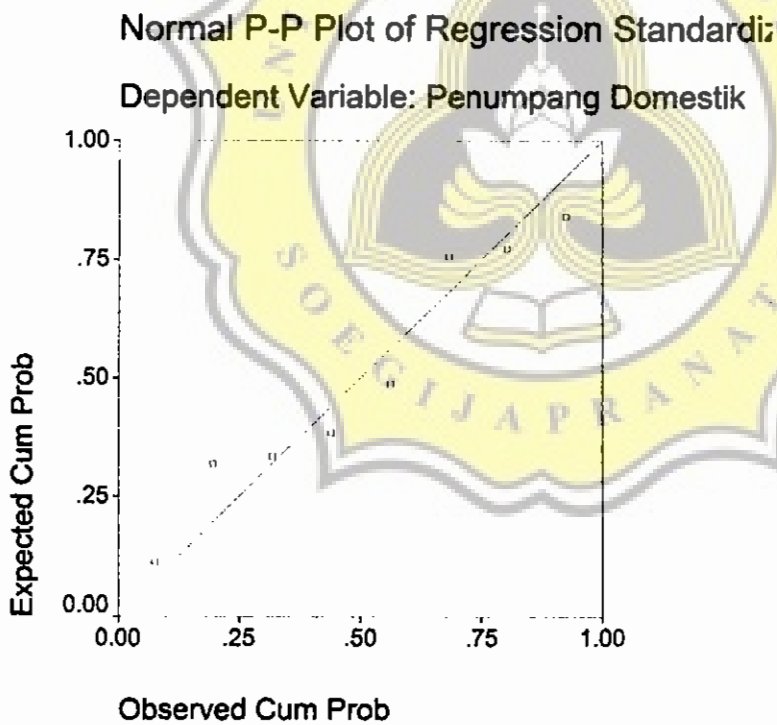

# Regression

## Descriptive Statistics

	Mean	Std. Deviation	N
Penumpang Internasional	39271.000	28909.4195	7
Jumlah wisatawan	3203382.7	267785.2081	7
PDRB	38607738	3305648.4954	7
Income Perkapita	1117390.0	98111.0269	7

## Correlations

		Penumpang Internasional	Jumlah wisatawan	PDRB	Income Perkapita
Pearson Correlation	Penumpang Internasional	1.000	-.970	.261	.072
	Jumlah wisatawan	-.970	1.000	-.133	.030
	PDRB	.261	-.133	1.000	.964
	Income Perkapita	.072	.030	.964	1.000
Sig. (1-tailed)	Penumpang Internasional		.000	.286	.439
	Jumlah wisatawan	.000		.388	.475
	PDRB	.286	.388		.000
	Income Perkapita	.439	.475	.000	
N	Penumpang Internasional	7	7	7	7
	Jumlah wisatawan	7	7	7	7
	PDRB	7	7	7	7
	Income Perkapita	7	7	7	7

## Variables Entered/Removed<sup>b</sup>

Model	Variables Entered	Variables Removed	Method
1	Income Perkapita, Jumlah wisatawan, PDRB		Enter

a. All requested variables entered.

b. Dependent Variable: Penumpang Internasional

## Model Summary

Model	R	R Square	Adjusted R Square	Std. Error of the Estimate
1	.989 <sup>a</sup>	.979	.958	5921.9272

### Model Summary

Model	Change Statistics				
	R Square Change	F Change	df1	df2	Sig. F Change
1	.979	46.663	3	3	.005

a. Predictors: (Constant), Income Perkapita, Jumlah wisatawan, PDRB

### ANOVA<sup>b</sup>

Model		Sum of Squares	df	Mean Square	F	Sig.
1	Regression	4.91E+09	3	1636439845.2	46.663	.005 <sup>a</sup>
	Residual	1.05E+08	3	35069221.444		
	Total	5.01E+09	6			

a. Predictors: (Constant), Income Perkapita, Jumlah wisatawan, PDRB

b. Dependent Variable: Penumpang Internasional

### Coefficients<sup>a</sup>

Model		Unstandardized Coefficients		Standardized Coefficients	t	Sig.
		B	Std. Error	Beta		
1	(Constant)	284617.81	49185.167		5.787	.010
	Jumlah wisatawan	-9.152E-02	.011	-.848	-8.060	.004
	PDRB	6.804E-03	.003	.778	1.972	.143
	Income Perkapita	-.192	.115	-.653	-1.668	.194

a. Dependent Variable: Penumpang Internasional

### Charts

Normal P-P Plot of Regression Standardized Residuals  
 Dependent Variable: Penumpang Internasional

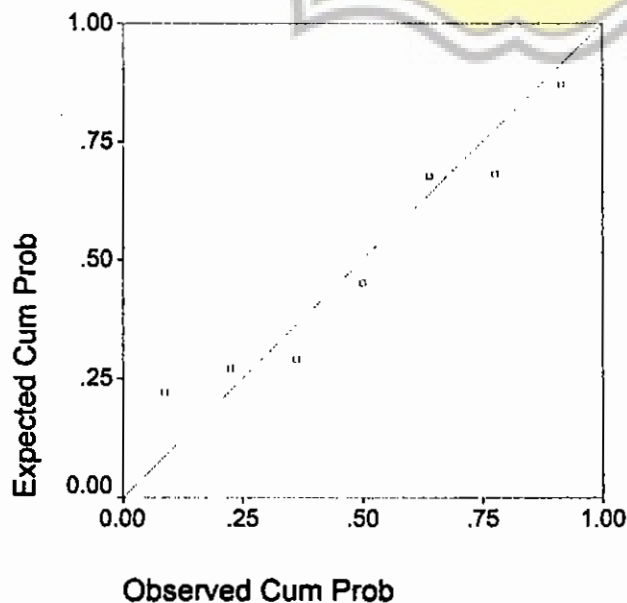

# Regression

## Descriptive Statistics

	Mean	Std. Deviation	N
Barang Domestik	1700274.6	354143.7210	7
Jumlah wisatawan	3203382.7	267785.2081	7
PDRB	38607738	3305648.4954	7
Income Perkapita	1117390.0	98111.0269	7

## Correlations

		Barang Domestik	Jumlah wisatawan	PDRB	Income Perkapita
Pearson Correlation	Barang Domestik	1.000	.913	.022	.163
	Jumlah wisatawan	.913	1.000	-.133	.030
	PDRB	.022	-.133	1.000	.964
	Income Perkapita	.163	.030	.964	1.000
Sig. (1-tailed)	Barang Domestik	.	.002	.481	.363
	Jumlah wisatawan	.002	.	.388	.475
	PDRB	.481	.388	.	.000
	Income Perkapita	.363	.475	.000	.
N	Barang Domestik	7	7	7	7
	Jumlah wisatawan	7	7	7	7
	PDRB	7	7	7	7
	Income Perkapita	7	7	7	7

## Variables Entered/Removed<sup>b</sup>

Model	Variables Entered	Variables Removed	Method
1	Income Perkapita, Jumlah wisatawan, PDRB		Enter

- a. All requested variables entered.  
 b. Dependent Variable: Barang Domestik

## Model Summary

Model	R	R Square	Adjusted R Square	Std. Error of the Estimate
1	.924 <sup>a</sup>	.854	.708	191232.9560

## Model Summary

Model	Change Statistics				
	R Square Change	F Change	df1	df2	Sig. F Change
1	.854	5.859	3	3	.090

- a. Predictors: (Constant), Income Perkapita, Jumlah wisatawan, PDRB



ANOVA<sup>b</sup>

Model		Sum of Squares	df	Mean Square	F	Sig.
1	Regression	6.43E+11	3	2.1427E+11	5.859	.090 <sup>a</sup>
	Residual	1.10E+11	3	36570043472		
	Total	7.53E+11	6			

a. Predictors: (Constant), Income Perkapita, Jumlah wisatawan, PDRB

b. Dependent Variable: Barang Domestik

Coefficients<sup>a</sup>

Model		Unstandardized Coefficients		Standardized Coefficients	t	Sig.
		B	Std. Error	Beta		
1	(Constant)	-2923243	1588304.7		-1.840	.163
	Jumlah wisatawan	1.254	.367	.948	3.420	.042
	PDRB	2.632E-02	.111	.246	.236	.828
	Income Perkapita	-.367	3.722	-.102	-.099	.928

a. Dependent Variable: Barang Domestik

Charts

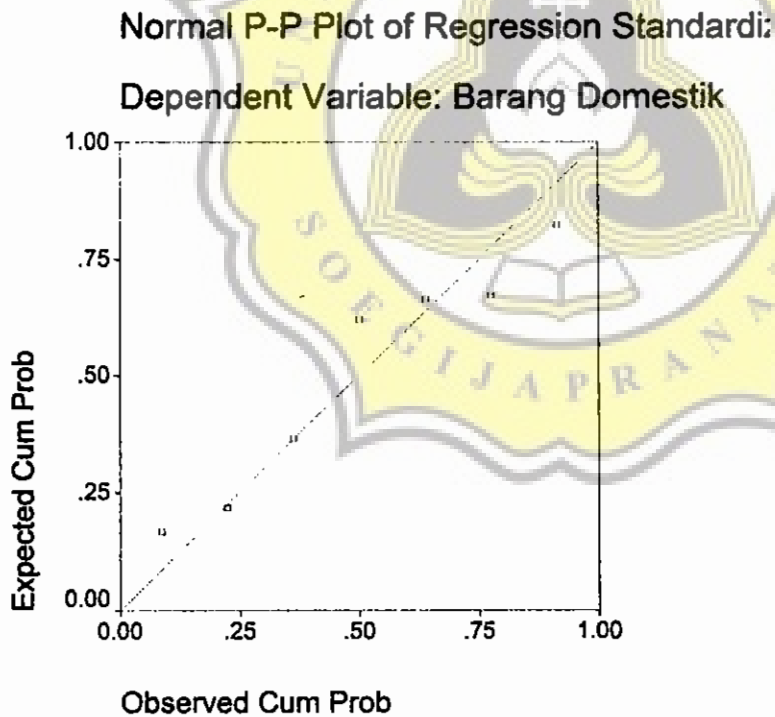

# Regression

## Descriptive Statistics

	Mean	Std. Deviation	N
Barang Internasional	102076.78	138423.6611	9
Jumlah wisatawan	3180141.1	264686.0153	9
PDRB	38733838	3025243.0221	9
Income Perkapita	1123466.5	93479.3918	9

## Correlations

		Barang Internasional	Jumlah wisatawan	PDRB	Income Perkapita
Pearson Correlation	Barang Internasional	1.000	-.640	-.084	-.205
	Jumlah wisatawan	-.640	1.000	.153	.241
	PDRB	-.084	.153	1.000	.954
	Income Perkapita	-.205	.241	.954	1.000
Sig. (1-tailed)	Barang Internasional	.	.032	.415	.298
	Jumlah wisatawan	.032	.	.347	.266
	PDRB	.415	.347	.	.000
	Income Perkapita	.298	.266	.000	.
N	Barang Internasional	9	9	9	9
	Jumlah wisatawan	9	9	9	9
	PDRB	9	9	9	9
	Income Perkapita	9	9	9	9

## Variables Entered/Removed<sup>b</sup>

Model	Variables Entered	Variables Removed	Method
1	Income Perkapita, Jumlah wisatawan, PDRB		Enter

a. All requested variables entered.

b. Dependent Variable: Barang Internasional

## Model Summary

Model	R	R Square	Adjusted R Square	Std. Error of the Estimate
1	.679 <sup>a</sup>	.462	.139	128478.2020

## Model Summary

Model	Change Statistics				
	R Square Change	F Change	df1	df2	Sig. F Change
1	.462	1.429	3	5	.339

a. Predictors: (Constant), Income Perkapita, Jumlah wisatawan, PDRB

ANOVA<sup>b</sup>

Model		Sum of Squares	df	Mean Square	F	Sig.
1	Regression	7.08E+10	3	23585212568	1.429	.339 <sup>a</sup>
	Residual	8.25E+10	5	16506648377		
	Total	1.53E+11	8			

a. Predictors: (Constant), Income Perkapita, Jumlah wisatawan, PDRB

b. Dependent Variable: Barang Internasional

Coefficients<sup>a</sup>

Model		Unstandardized Coefficients		Standardized Coefficients	t	Sig.
		B	Std. Error	Beta		
1	(Constant)	1014643.4	767401.70		1.322	.243
	Jumlah wisatawan	-.295	.183	-.565	-1.612	.168
	PDRB	3.505E-02	.052	.766	.674	.530
	Income Perkapita	-1.185	1.713	-.800	-.692	.520

a. Dependent Variable: Barang Internasional

Charts

Normal P-P Plot of Regression Standardized Residuals  
 Dependent Variable: Barang Internasional

